

# XS8C40DP210

inductive sensor XS8 40x40x117 - plastic -  
Sn20mm - 12..48VDC - terminals

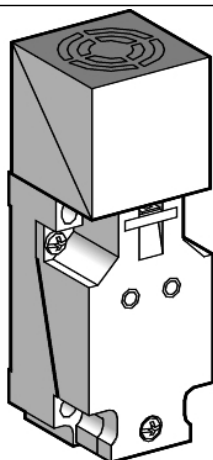

## Main

Range of product	Telemecanique Inductive proximity sensors XS
Series name	General purpose
Sensor type	Inductive proximity sensor
Device application	-
Sensor name	XS8
Sensor design	Form 40 x 40 x 117
Size	117 mm
Body type	Fixed
Detector flush mounting acceptance	Non flush mountable
Material	Plastic
Enclosure material	Plastic
Type of output signal	Discrete
Wiring technique	2-wire
[Sn] nominal sensing distance	20 mm
Discrete output function	1 NO or 1 NC programmable
Output circuit type	DC
Electrical connection	Screw-clamp terminals, 2 x 1.5 mm <sup>2</sup>
[Us] rated supply voltage	12...48 V DC with reverse polarity protection
Switching capacity in mA	1.5...100 mA with overload and short-circuit protection
IP degree of protection	IP67 conforming to IEC 60529

## Complementary

Detection face	5 positions turret head
Front material	Plastic
Operating zone	0...16 mm
Differential travel	3...20% of Sr
Repeat accuracy	<= 3% of Sr
Status LED	Output state: 1 LED (yellow)
Supply voltage limits	10...58 V DC
Maximum residual current	0.5 mA open state
Switching frequency	<= 800 Hz
Maximum voltage drop	<4 V (closed)
Maximum delay first up	5 ms
Maximum delay response	2 ms
Maximum delay recovery	7 ms
Marking	CE
Height	40 mm
Length	40 mm
Width	117 mm

## Environment

Product certifications	UL[RETURN]CSA[RETURN]CCC
Ambient air temperature for operation	-25...70 °C

### Packing Units

Unit Type of Package 1	PCE
Number of Units in Package 1	1

### Contractual warranty

Warranty	18 months
----------	-----------

## Dimensions

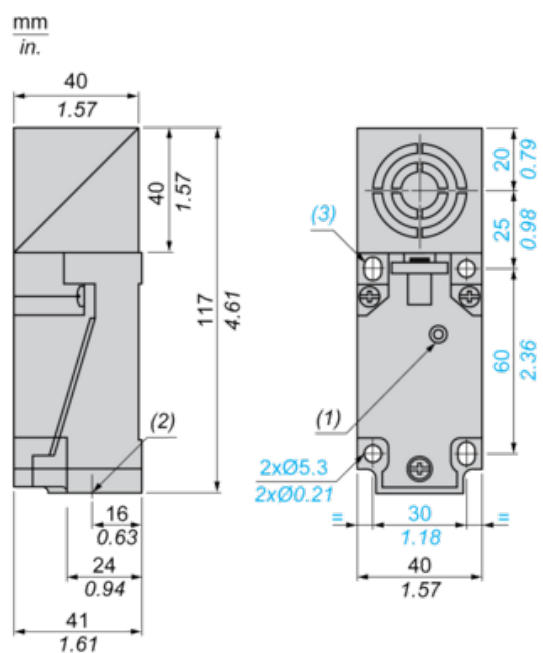

- (1) Output LED
- (2) 1 tapped entry for Pg 13.5 cable gland
- (3) 2 elongated holes Ø 5.3 x 7

---

## Setting-up

---

### Minimum Mounting Distances (mm)

Side by Side

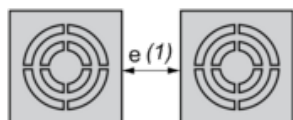

$$e(1) \geq 80$$

Face to Face

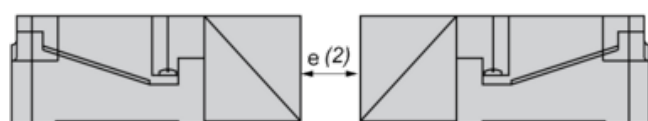

$$e(2) \geq 160$$

Facing a Metal Object

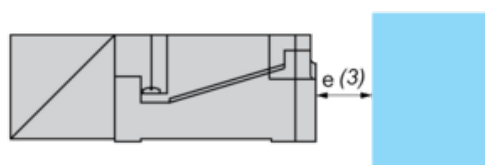

$$e(3) \geq 60$$

---

## Wiring Schemes

---

### 2-Wire DC (Non Polarised)

