

Main

| | |
|------------------------------------|---------------------------------|
| Accessory / separate part category | Mounting and fixing accessories |
| Accessory / separate part type | Fixing bracket |

Complementary

| | |
|---------------------------------------|----------------------------------|
| Accessory / separate part destination | Ø 58 mm encoder with solid shaft |
| Product compatibility | XCC2510P XCC3510P XCC1510P |
| Net weight | 0.13 kg |

Packing Units

| | |
|------------------------------|-------|
| Unit Type of Package 1 | PCE |
| Number of Units in Package 1 | 1 |
| Package 1 Height | 4 cm |
| Package 1 Width | 8 cm |
| Package 1 Length | 8 cm |
| Package 1 Weight | 136 g |

Offer Sustainability

| | |
|--|---|
| Toxic heavy metal free | Yes |
| California proposition 65 | WARNING: This product can expose you to chemicals including: Diisononyl phthalate (DINP), which is known to the State of California to cause cancer, and Di-isodecyl phthalate (DIDP), which is known to the State of California to cause birth defects or other reproductive harm. For more information go to www.P65Warnings.ca.gov |
| For all Reach Rohs enquiries contact us at | sustainability@tesensors.com |

Contractual warranty

| | |
|----------|-----------|
| Warranty | 18 months |
|----------|-----------|

Dimensions

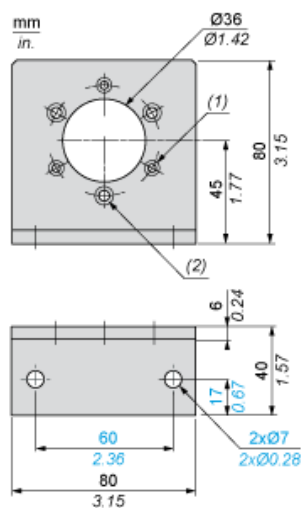

- (1) 3 counterbored holes for CHC M3 screws at 120° on 48 PCD
- (2) 3 counterbored holes for CHC M4 screws at 120° on 48 PCD